



SUMMER INSTITUTE 2009

KNOWLEDGE FOR A CHANGE



July 7-9, 2009, Mont-Sainte-Anne, Quebec
National Collaborating Centres for Public Health

MAPS OF THE HOTEL AND CONVENTION CENTRE

HOTEL

Ground floor

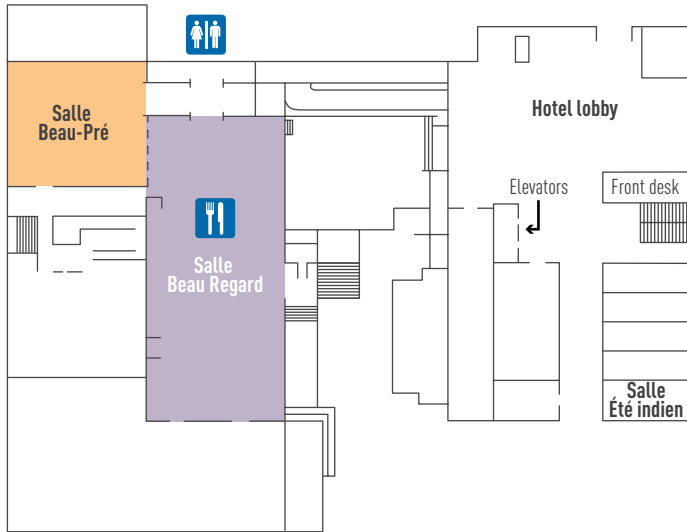

Convention level

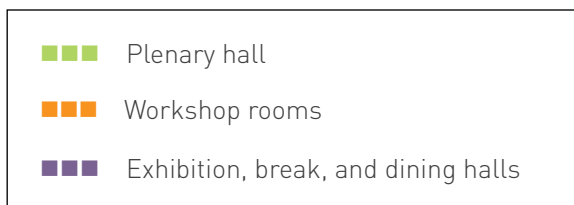
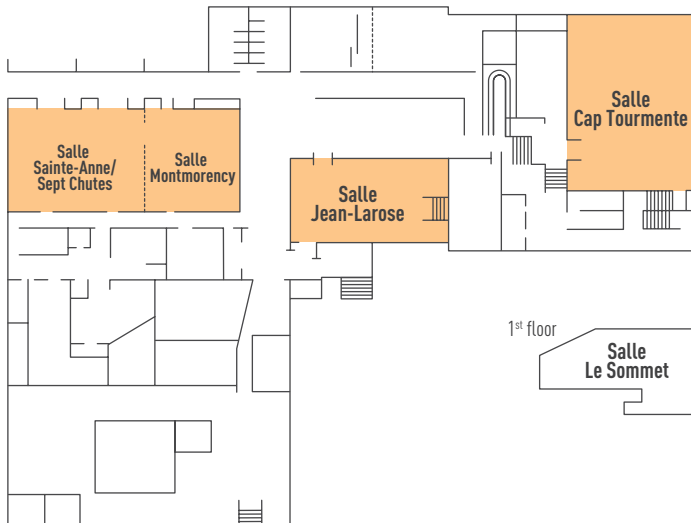

CONVENTION CENTRE

Salon Le Blizzard

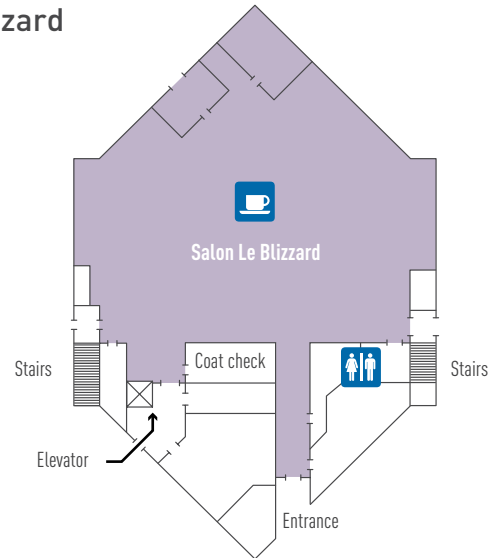

Salle Suroît/Noroît

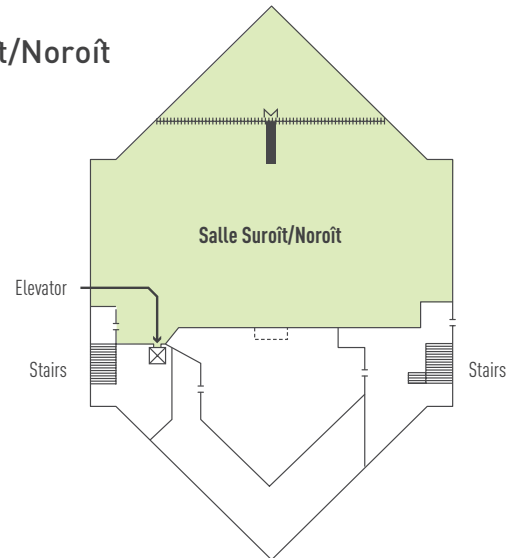

7^e Ciel

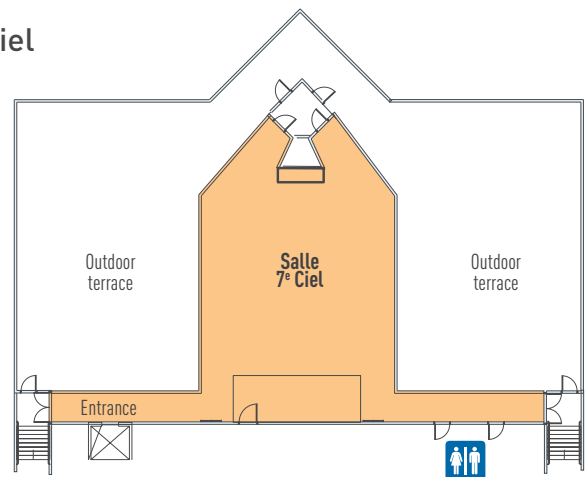

Dear Participants,

On behalf of the Organizing Committee, I am most pleased to welcome you to Mont-Sainte-Anne for the 4th edition of the Summer Institute of the National Collaborating Centres for Public Health (NCCPH). This year, our theme, *Knowledge for a Change*, reflects our desire to share what we have learned, so that together we can discover practical opportunities for inspiring change.

The presentations and workshops during the next three days will be oriented toward increasing knowledge about the specific work of each Centre and exploring how collaboration, networking and evaluation can influence the exchange and use of knowledge toward improving public health practices. We will consider, among other things, numerous innovative projects and their links to research, policy and practices.

Naturally, despite a varied and interesting program, this 4th Summer Institute cannot truly be successful without your active participation. Therefore, we invite you to share your perspectives and your experiences throughout this event. Numerous opportunities for networking have been integrated into the program so that these three days will constitute not only an opportunity for you to learn more about the Centres' activities and about knowledge translation, but also an opportunity for us to identify the needs of public health actors so as to better meet them.

In closing, it is our sincere hope that you will leave this event equipped with practical tools that can help you to accomplish the various tasks you face in your respective work environments.

Have a good 2009 Summer Institute!

François Benoit

Lead, National Collaborating Centre for Healthy Public Policy
Host of the 2009 Summer Institute

2009 Summer Institute Organizing Committee

François Benoit

National Collaborating Centre
for Healthy Public Policy

Elsabé du Plessis

National Collaborating Centre
for Infectious Diseases

Lucie Essiembre

Public Health Agency of Canada

Pamela Forsyth

National Collaborating Centre
for Methods and Tools

Philip Girvan

Leads Secretariat
National Collaborating Centres for Public Health

Geneviève Hamel

National Collaborating Centre
for Healthy Public Policy

Isabelle Hémon

National Collaborating Centre
for Healthy Public Policy

Marianne Jacques

National Collaborating Centre
for Healthy Public Policy

Michael Keeling

National Collaborating Centre
for Healthy Public Policy

Faith Layden

National Collaborating Centre
for Determinants of Health

Kim Payette-Chapleau

National Collaborating Centre
for Healthy Public Policy

Mona Shum

National Collaborating Centre
for Environmental Health

Ginette Thomas

National Collaborating Centre for Aboriginal Health



PROGRAM AT A GLANCE

TUESDAY JULY 7

COLLABORATING FOR A CHANGE

6:30 a.m.

BREAKFAST
Salle Beau Regard

7:15 a.m.

TRANSLATION EQUIPMENT
PICK UP
Hotel lobby

8:30 a.m.

OPENING CEREMONY AND WELCOME
Salle Suroît/Noroît

9:00 a.m.

OPENING KEYNOTE
Salle Suroît/Noroît

9:45 a.m.

NUTRITION BREAK
Salon Le Blizzard

10:15 a.m.

PLENARY PANEL
Salle Suroît/Noroît

11:00 a.m.

INTERACTIVE SESSION
Salle Suroît/Noroît

12:00 p.m.

LUNCH
Salle Beau Regard

1:30 p.m.

PLENARY PANEL
Salle Suroît/Noroît

2:45 p.m.

NUTRITION BREAK
Salon Le Blizzard

3:15 p.m.

CONCURRENT SHOWCASING SESSIONS

NCCDH

Salle Beau-Pré

NCCHPP

Salle Sainte-Anne/Sept Chutes

NCCMT

Salle Cap Tourmente

NCCID

Salle 7^e Ciel

NCCA

Salle Jean-Larose

NCCEH

Salle Montmorency

4:30 p.m.

END OF TUESDAY'S SESSIONS

5:30 p.m.

OPENING RECEPTION
Salle Suroît/Noroît

WEDNESDAY JULY 8

NETWORKING FOR A CHANGE

6:30 a.m.

BREAKFAST
Salle Beau Regard

7:15 a.m.

TRANSLATION EQUIPMENT
PICK UP
Hotel lobby

8:30 a.m.

KEYNOTE
Salle Suroît/Noroît

9:30 a.m.

NUTRITION BREAK
Salon Le Blizzard

10:00 a.m.

KNOWLEDGE FAIR
Salon Le Blizzard

12:00 p.m.

LUNCH
Salle Beau Regard

1:30 p.m.

CONCURRENT TRAINING SESSIONS

NCCDH

Salle Beau-Pré

NCCHPP

Salle Sainte-Anne/Sept Chutes

NCCMT

Salle Cap Tourmente

NCCID

Salle 7^e Ciel

3:00 p.m.

NUTRITION BREAK
Salon Le Blizzard

3:30 p.m.

CONCURRENT TRAINING SESSIONS
(CONTINUED)

5:00 p.m.

END OF WEDNESDAY'S SESSIONS

5:15 p.m.

FREE EVENING IN QUÉBEC CITY

THURSDAY JULY 9

EVALUATING FOR A CHANGE

6:30 a.m.

BREAKFAST
Salle Beau Regard

7:15 a.m.

TRANSLATION EQUIPMENT
PICK UP
Hotel lobby

8:30 a.m.

KEYNOTE
Salle Suroît/Noroît

9:30 a.m.

CONCURRENT TRAINING SESSIONS

NCCHPP

Salle Sainte-Anne/Sept Chutes

NCCMT

Salle Cap Tourmente

NCCEH

Salle Beau-Pré

NCCA

Salle 7^e Ciel

10:15 a.m.

NUTRITION BREAK
Salon Le Blizzard

10:45 a.m.

CONCURRENT TRAINING SESSIONS
(CONTINUED)

12:15 p.m.

LUNCH
Salle Beau Regard

1:30 p.m.

PLENARY PANEL
Salle Suroît/Noroît

2:45 p.m.

NUTRITION BREAK
Salle Suroît/Noroît

3:00 p.m.

CLOSING KEYNOTE
Salle Suroît/Noroît

3:45 p.m.

CLOSING REMARKS
Salle Suroît/Noroît

4:00 p.m.

END OF THE 2009 SUMMER INSTITUTE

NCCDH National Collaborating Centre for Determinants of Health

NCCHPP National Collaborating Centre for Healthy Public Policy

NCCMT National Collaborating Centre for Methods and Tools

NCCID National Collaborating Centre for Infectious Diseases

NCCA National Collaborating Centre for Aboriginal Health

NCCEH National Collaborating Centre for Environmental Health

TUESDAY JULY 7

COLLABORATING FOR A CHANGE

SIMULTANEOUS TRANSLATION WILL BE OFFERED FOR ALL SESSIONS, INCLUDING WORKSHOPS, AND BILINGUAL RESOURCE PEOPLE WILL BE AVAILABLE DURING NETWORKING SESSIONS.

6:30 a.m. - 8:15 a.m.
Salle Beau Regard

BREAKFAST



8:30 a.m. - 9:00 a.m.
Salle Suroît/Noroît

OPENING CEREMONY

Marcel Godbout, Huron-Wendat



OPENING REMARKS

François Benoit, Lead, National Collaborating Centre for Healthy Public Policy, Quebec, Canada

9:00 a.m. - 9:45 a.m.
Salle Suroît/Noroît

OPENING KEYNOTE

Making Research on Public Health Accessible to the Public



André Picard, Health Reporter, *The Globe and Mail*, Canada

9:45 a.m. - 10:15 a.m.
Salon Le Blizzard

NUTRITION BREAK

Poster area



10:15 a.m. - 11:00 a.m.
Salle Suroît/Noroît

PLENARY PANEL

Overview of the National Collaborating Centres for Public Health



In this session, the Leads, Scientific and Academic Directors of the six National Collaborating Centres will provide an overview of the collective NCC program and the work that they are undertaking in knowledge synthesis, translation and exchange (KSTE).

11:00 a.m. - 12:00 p.m.
Salle Suroît/Noroît

INTERACTIVE SESSION

Knowledge translation and dissemination are fundamental to the work of the NCCs. But just how knowledgeable are we about these topics? During this interactive session, participants will have the opportunity to share their knowledge about knowledge translation and dissemination. Participants will be asked specific questions related to KSTE and will then be asked to debate in small tables to come up with agreed-upon responses.



Facilitators

Donna Ciliska, Scientific Director, National Collaborating Centre for Methods and Tools, and Professor, McMaster University, Ontario, Canada

François Chagnon, Professor, Département de psychologie, Faculté des sciences humaines, Université du Québec à Montréal, Quebec, Canada

12:00 p.m. - 1:15 p.m.
Salle Beau Regard

LUNCH



1:30 p.m. - 2:45 p.m.
Salle Suroît/Noroît

PLENARY PANEL

Collaboration and Public Health: Different Ways to Work Together



Public health actors are confronted with complex problems that often require multiple types of expertise in order to find effective solutions. Our two guest speakers will address different types of collaboration dynamics that can facilitate the development of better public health practices.

Jacques Bourgault, Co-researcher and Associate Professor, École nationale d'administration publique, and Professor, Université du Québec à Montréal, Quebec, Canada

Roz Lasker, Clinical Professor of Public Health, Department of Health Policy and Management, Mailman School of Public Health, Columbia University, United States

2:45 p.m. - 3:15 p.m.
Salon Le Blizzard

NUTRITION BREAK

Poster area



3:15 p.m. - 4:30 p.m.

CONCURRENT SHOWCASING SESSIONS



Salle Beau-Pré

NCCDH

World Health Organization Commission on the Social Determinants of Health: Early Child Development as a Determinant of Health

Description

The NCCDH aims to provide leadership and support to the public health community to create the conditions for children to thrive equally through their physical, social/emotional, and language/cognitive development.

Children are the youngest and most vulnerable members of our society (Irwin, Siddiqi & Hertzman, 2007). The conditions in which children grow and develop are among the most important determinants of health throughout their lives. Therefore, networking and partnering to address health inequities as they relate to children is a central activity of the NCCDH. This workshop is the result of partnerships with the Canadian Reference Group for Social Determinants of Health and the Human Early Learning Partnership.

Resource Person

The Honourable Landon Pearson, Landon Pearson Resource Centre for the Study of Childhood and Children's Rights, Ontario, Canada

TUESDAY JULY 7

COLLABORATING FOR A CHANGE

SIMULTANEOUS TRANSLATION WILL BE OFFERED FOR ALL SESSIONS, INCLUDING WORKSHOPS, AND BILINGUAL RESOURCE PEOPLE WILL BE AVAILABLE DURING NETWORKING SESSIONS.

Salle Sainte-Anne/
Sept Chutes



NCCHPP

The Methods Used by Non-Profit Organizations to Influence Public Policy and the Implications of these for Public Health Actors Working Toward the Development of Healthy Public Policies

Description

The process of developing healthy public policies, in which some public health actors are engaged, inevitably involves intersectoral action. The NCCHPP is interested in the various dimensions of intersectoral action related to healthy public policy development and is engaged in documenting certain Canadian experiences. This workshop will examine the role played by non-profit organizations (NPOs) as “non-traditional” public health actors in public policy processes.

Involving new partners, such as NPOs, in public policy processes requires forming an understanding of their practices, including, notably, the way they frame problems and justify the solutions they propose, the objectives they target and the strategies they use. During this session, the NCCHPP will present a few of its studies of the methods used by five Canadian non-profit organizations to influence public policy, thus illustrating various dimensions of these practices. The implications of these practices for public health actors will be discussed.

Resource People

François Gagnon, Research Officer, National Collaborating Centre for Healthy Public Policy, Quebec, Canada

Val Morrison, Research Officer, National Collaborating Centre for Healthy Public Policy, Quebec, Canada

Salle
Cap Tourmente



NCCMT

Finding, Sharing, and Using Evidence with New Tools and Skills You Can Use

Description

This three-part session will present three tools from the NCCMT.

Part I will present the Registry of Public Health Knowledge Translation Methods and Tools, an innovative Canadian model that uses web-based technology to facilitate uptake of critically appraised knowledge translation methods and tools by public health stakeholders in various roles. The registry includes an online searchable database with an interactive, moderated discussion board where members can discuss key knowledge translation issues and challenges arising in public health.

Part II will present DialoguePH, a networking tool that aims to strengthen the capacity of Canada’s public health workforce by bringing people together to develop and/or share knowledge translation methods and tools to increase effectiveness, efficiencies and sharing. This presentation will highlight the findings from a recent needs assessment involving the network’s membership.

Part III will focus on the Online Health Program Planner (OHPP), a tool that has been developed for individuals involved in health planning at the community level. It was developed by The Health Communication Unit in partnership with the National Collaborating Centre for Methods and Tools. This presentation will provide an overview of the planning tool, including an exploration of the website worksheets, the learning centre, and help functions.

Resource People

Cristina Catalo, Research Coordinator, National Collaborating Centre for Methods and Tools, Ontario, Canada

Kathie Clark, Administrative Director, National Collaborating Centre for Methods and Tools, Ontario, Canada

Larry Hershfield, Manager, The Health Communication Unit, Centre for Health Promotion, Ontario, Canada

Pamela Forsyth, Knowledge Broker, National Collaborating Centre for Methods and Tools, Ontario, Canada

Salle 7^e Ciel



NCCID

Benefits of an Integrated Knowledge Exchange Model Involving Partners - The NCCID Experience

Description

The National Collaborating Centre for Infectious Diseases' (NCCID) knowledge synthesis and exchange model has evolved into an integrated, comprehensive approach that strives to transfer knowledge from theoretical and applied research to practical applicability for public health practitioners, managers and decision-makers, in a strategic and pragmatic manner.

This session will describe the NCCID's strategy, elucidating how the NCCID's various knowledge-related products and activities fit into and inform the broader continuum of knowledge translation objectives. Important partnerships and collaborations as well as the important role of networking in establishing and maintaining relationships will be highlighted.

Resource People

Dr. Carl Bognar, Chair, Board of Directors, Health Initiative for Men, British Columbia, Canada

Margaret Fast, Scientific Director, National Collaborating Centre for Infectious Diseases, Manitoba, Canada

Pascale Robitaille, Outreach Worker, Stella, Quebec, Canada

Salle Jean-Larose



NCCAH

A Chronicle of the Engagement Process for the Social Determinants of Indigenous Health

Description

There has been growing interest in the social determinants of Indigenous health at the international level. This session will describe the process that was undertaken to bring together First Nations, Inuit and Métis organizations in order to provide an opportunity for their voices to be heard, at the international level, on the subject of social determinants of health as they affect Indigenous communities.

Resource Person

Margo Greenwood, Academic Leader, National Collaborating Centre for Aboriginal Health, British Columbia, Canada

Salle
Montmorency



NCCEH

Process for Knowledge Translation

Description

In this showcasing session, the NCCEH will share the process they have derived for involving their user group in every step of their knowledge translation product development.

They will review their process for first identifying priorities, scoping out focus questions to be answered, incorporating user ideas and input, and having users review their products before and after distribution. The lessons learned to date will be described. This session will also allow the NCCEH to explore how their approach fits in with the current KSTE literature.

Resource People

Christina Chociolko, Network Coordinator, National Collaborating Centre for Environmental Health, British Columbia, Canada

Mona Shum, Manager, National Collaborating Centre for Environmental Health, British Columbia, Canada

5:30 p.m.
Salle Suroît/Noroît



OPENING RECEPTION

The Public Health System in Quebec: Learnings and Challenges

Dr. Luc Boileau, the Chief Executive Officer of the Institut national de santé publique du Québec, will briefly present Quebec's public health system, the links that unify the different organizations and actors, as well as the challenges connected to their development during the coming years.

Dinner, social and networking time will follow.

WEDNESDAY JULY 8

NETWORKING FOR A CHANGE

SIMULTANEOUS TRANSLATION WILL BE OFFERED FOR ALL SESSIONS, INCLUDING WORKSHOPS, AND BILINGUAL RESOURCE PEOPLE WILL BE AVAILABLE DURING NETWORKING SESSIONS.

6:30 a.m. - 8:15 a.m.
Salle Beau Regard

BREAKFAST



8:30 a.m. - 9:30 a.m.
Salle Suroît/Noroît

KEYNOTE

Networks - How Can they Be Useful to Public Health Actors?

Networks are an important tool for public health practitioners. They allow multiple actors to share good practices, manage public health knowledge and act as a source of learning and professional development. Our guest speaker will offer insights as to how public health networks can facilitate knowledge sharing and improve public health practices.

Brint Milward, Providence Service Corporation Chair, Associate Dean and Director, School of Public Administration and Policy, Eller College of Management, University of Arizona, United States

9:30 a.m. - 10:00 a.m.
Salon Le Blizzard

NUTRITION BREAK

Poster area



10:00 a.m. - 12:00 p.m.
Salon Le Blizzard

KNOWLEDGE FAIR

The NCCs invite you to share and exchange with public health actors from across the country. Participants will be guided through the exhibition hall to visit with the NCCs, to discover the different tools and resources available, and to meet and discuss diverse projects and areas of interest. This will be an opportunity for participants and NCC staff to engage in a pan-Canadian exchange across various public health sectors in order to share practices, outline interests and develop potential collaborations.

12:00 p.m. - 1:15 p.m.
Salle Beau Regard

LUNCH



1:30 p.m. - 5:00 p.m.



CONCURRENT TRAINING SESSIONS

Salle Beau-Pré



NCCDH

Taking Action on the Determinants of Health and Building on the Evidence for Healthy Child Development: The Total Environment Assessment Model of Early Child Development (TEAM - ECD)

Description

The World Health Organization Knowledge Network Report, *Early Child Development: A Powerful Equalizer*, proposed the Total Environment Assessment Model of Early Child Development (TEAM-ECD), an equity-based approach and framework for understanding the environments that play a role in providing nurturant conditions for children in their early years. The TEAM-ECD model illustrates how the socioeconomic environment is fundamental to early child development and, in turn, that early child development (which includes the physical, social/emotional and language/cognitive domains) is the most important determinant of health and well-being across the balance of the life course.

This training session will explore the utility of the TEAM-ECD as a guide to public health program and policy development and to collaborative practice in Canada.



Salle Sainte-Anne/
Sept Chutes



NCCHP

Using Deliberative Processes to Inform the Development of Healthy Public Policies

Description

Deliberative processes can be used to inform the development of healthy public policies. A deliberative process refers to a process during which a policy issue is critically examined by a group of participants (experts, policy-makers, the public and other relevant actors). Information is presented to participants (e.g. a knowledge synthesis or oral presentations) and generally serves as a starting point for group deliberation. The objective is to arrive at a rationally-motivated decision that considers all relevant forms of evidence.

During this training session, the facilitators will present a review of the literature and will recommend fruitful lines of inquiry for shedding more light on three deliberative approaches: expert, citizen, and hybrid deliberative processes. The presenters will also share their experiences to bring a hands-on dimension to the session. Participants will be invited to share their experiences and thoughts during a plenary discussion.

Resource People

Elisabeth Martin, PhD candidate, Department of Community Health, Université Laval, Quebec, Canada

François-Pierre Gauvin, Research Officer, National Collaborating Centre for Healthy Public Policy, Quebec, Canada

Salle
Cap Tourmente



NCCMT

LESS is MORE - Efficient Search Strategies for Everyday Work Life

Description

How do you find the best available research evidence in 5 minutes or less? This workshop will examine search strategies and approaches that can be used to find pre-appraised and synthesized research that will save you time in finding answers to your program, clinical and policy questions.

Resource People

Ann McKibbin, Associate Professor, Department of Clinical Epidemiology & Biostatistics, Health Information Research Unit, McMaster University, Ontario, Canada

Donna Ciliska, Scientific Director, National Collaborating Centre for Methods and Tools, and Professor, McMaster University, Ontario, Canada

Salle 7^e Ciel



NCCID

Mapping for Public Health

Description

This workshop will explore the often neglected third component of the epidemiological triad, namely, place. In public health, mapping can be used to illustrate the geographic distribution of diseases, populations at risk, and resource availability. Mapping can also be used to analyze spatial and temporal trends. The use of mapping can also facilitate the exchange of knowledge by visually presenting results to the public as well as decision makers. The visual presentation of information can also promote collaboration and participatory decision-making.

Resource People

Dr. Cory Neudorf, Chief Medical Health Officer, Saskatoon Health Region, Saskatchewan, Canada

Dr. David Buckeridge, Assistant Professor, McGill University, Quebec, Canada

Nina Wesch, Program Advisor, Public Health, GeoConnections, Ontario, Canada

5:15 p.m.



FREE EVENING IN QUÉBEC CITY

THURSDAY JULY 9

EVALUATING FOR A CHANGE

SIMULTANEOUS TRANSLATION WILL BE OFFERED FOR ALL SESSIONS, INCLUDING WORKSHOPS, AND BILINGUAL RESOURCE PEOPLE WILL BE AVAILABLE DURING NETWORKING SESSIONS.

6:30 a.m. - 8:15 a.m. **BREAKFAST**
Salle Beau Regard

8:30 a.m. - 9:15 a.m. **KEYNOTE**
Salle Suroît/Noroît

Ability of Non-Clinical Professionals to Absorb Scientific Research

Mathieu Ouimet, Co-researcher and Assistant Professor, Université Laval, Quebec, Canada

9:30 a.m. - 12:15 p.m. **CONCURRENT TRAINING SESSIONS**

Salle Sainte-Anne/
Sept Chutes

NCCHPP
**Public Policy Development Processes:
What Role Can Public Health Actors Play?**

Description

How are public policies developed? How can public health actors participate effectively in public policy development processes? The aim of this workshop is to introduce participants to some basic concepts related to public policy and to shed light on the complexity of the issues tied to policy development.

Resource Person

Patrick Fafard, Assistant Professor, Graduate School of Public and International Affairs, University of Ottawa, Ontario, Canada

Salle
Cap Tourmente

NCCMT
**The Online Health Program
Planner (OHPP)**

Description

The Online Health Program Planner (OHPP) is a tool for individuals involved in health planning at the community level. The OHPP provides accessible links to research and other evidence for use in the context of planning programs involving policy and community practice. This workshop will provide an overview of the planning tool, including an exploration of the website's worksheets, learning centre, and help functions.

The OHPP was developed by The Health Communication Unit (THCU) with support from the National Collaborating Centre for Methods and Tools (NCCMT), and is jointly promoted by THCU, the NCCMT and the Public Health Agency of Canada's Canadian Best Practices Initiative.

Resource People

Grace Wan Te, Analyst, Canadian Best Practices Initiative, Public Health Agency of Canada, Ontario, Canada

Kathie Clark, Administrative Director, National Collaborating Centre for Methods and Tools, Ontario, Canada

Larry Hershfield, Manager, The Health Communication Unit, Centre for Health Promotion, University of Toronto, Ontario, Canada

GREEN INITIATIVES AT THIS YEAR'S SUMMER INSTITUTE

- The purchase of Gold Standard certified offsets to reduce the impact of emissions caused by the Summer Institute and by participants' travel to and from the event, in order to hold a carbon-neutral event;
- The choice of Château Mont-Sainte-Anne for its emphasis on local and organic food, energy and resource conservation, waste reduction, recycling programs and responsible purchasing;
- The production of a shorter program on 100% recycled paper, and less paper use generally by emphasizing the use of electronic communications;
- The purchase of local gifts for presenters and locally-made, reusable bags for participants;
- The organization of a shuttle bus service for collective transport for participants;
- The ongoing effort to encourage organizers and participants to practice the three R's: reduce, re-use, and recycle before, during and after the event.

Find out more by visiting the Summer Institute website at www.si2009.ca.



Salle Beau-Pré

**NCCEH****How Do You Make Evidence-Informed Decisions in the Absence of Sufficient Evidence?****Description**

The NCCEH will illustrate what steps can be taken to evaluate limited evidence pertaining to environmental health in order to inform decision-making. A case example will be used to demonstrate the process of critical appraisal of limited evidence and its use in decision-making. After the theory is described, participants will split into working groups where they will critically evaluate evidence. Each working group will then share its findings with the larger group and draw general conclusions integrating the evidence with other factors to support a decision.

Resource People

Christina Chociolko, Network Coordinator, National Collaborating Centre for Environmental Health, British Columbia, Canada

Donna Ciliska, Scientific Director, National Collaborating Centre for Methods and Tools, and Professor, McMaster University, Ontario, Canada

Mona Shum, Manager, National Collaborating Centre for Environmental Health, British Columbia, Canada

Sophie Verhille, Knowledge Translation Scientist, National Collaborating Centre for Environmental Health, British Columbia, Canada

Salle 7^e Ciel**NCCAH****Finding Your Way in First Nations, Inuit and Métis Health****Description**

This workshop will provide background information about First Nations, Inuit and Métis health in Canada. Policy makers, practitioners and researchers who are new to the topic of First Nations, Inuit and Métis health and have an interest in learning about the public health issues and challenges that face First Nations, Inuit and Métis peoples in Canada will be provided with background knowledge about First Nations, Inuit and Métis public health.

Resource People

Ginette Thomas, Managing Director, National Collaborating Centre for Aboriginal Health, British Columbia, Canada

Margo Greenwood, Academic Leader, National Collaborating Centre for Aboriginal Health, British Columbia, Canada

12:15 p.m. - 1:15 p.m.

Salle Beau Regard

**LUNCH**

1:30 p.m. - 2:45 p.m.

Salle Suroît/Noroît

**PLENARY PANEL****Evaluation and Knowledge Translation in Public Health: Why and How?**

Evaluating the effects of public health actions is important when looking at how to improve the quality and the efficiency of our practices. According to their respective areas of interest and expertise, our panellists will share their evaluation experiences in various sectors of activity in public health. These presentations will highlight certain tools that can facilitate your own understanding of - and practices in - evaluation in the public health sector.

Developing a Tool to Measure Knowledge Exchange Outcomes

Kelly Skinner, PhD candidate, Department of Health Studies and Gerontology, University of Waterloo, Ontario, Canada

Assessment of and Support for Innovation in Public Health

Louise Potvin, Professor, Département de médecine sociale et préventive, Faculté de médecine, Université de Montréal, Quebec, Canada

Knowing What Works: Network Evaluation Lessons from a Child and Youth Health Network

Janice Popp, Former Director, Southern Alberta Child & Youth Health Network, Alberta, Canada

2:45 p.m. - 3:00 p.m.

Salle Suroît/Noroît

**NUTRITION BREAK****Grab and go refreshments**

3:00 p.m. - 3:45 p.m.

Salle Suroît/Noroît

**CLOSING KEYNOTE****Does Science Matter? Analysing Research-Policy-Practice Interactions in the Dutch Academic Collaborative Centres for Public Health**

Marleen Bekker, Assistant Professor, Department of Health Care Governance, Institute of Health Policy and Management, The Netherlands

3:45 p.m. - 4:00 p.m.

Salle Suroît/Noroît

**CLOSING REMARKS**



Graphic design: Le Groupe Flexidée



National Collaborating Centres
for Public Health

Centres de collaboration nationale
en santé publique



Public Health
Agency of Canada

Agence de la santé
publique du Canada

The National Collaborating Centres for Public Health are funded by the Public Health Agency of Canada.

